

Name:		
Location:		
Email:		
Phone:	Cell:	
Fax:	Cover: HL13 MONO	
Length:	Centers: 8', 10', 12', 14', 16'	Arc: 63'
Rafter Coating: ASTM-A123 Hot Dip Galvanized 3.9 mils Zinc		
Foundation:		

50' PROFILE ADVANTAGE TRUSS

THIS DOCUMENT CONTAINS
INFORMATION PROPRIETARY TO
ACCU-STEEL INC. IT SHALL NOT BE
REPRODUCED, USED, OR DISCLOSED
WITHOUT PRIOR WRITTEN
PERMISSION OF ACCU-STEEL INC.



Notes:

Date: 12/17/2010

Project:

Drawn By: JCB

Sales #

1-866-987-2534
www.advantagestructures.com

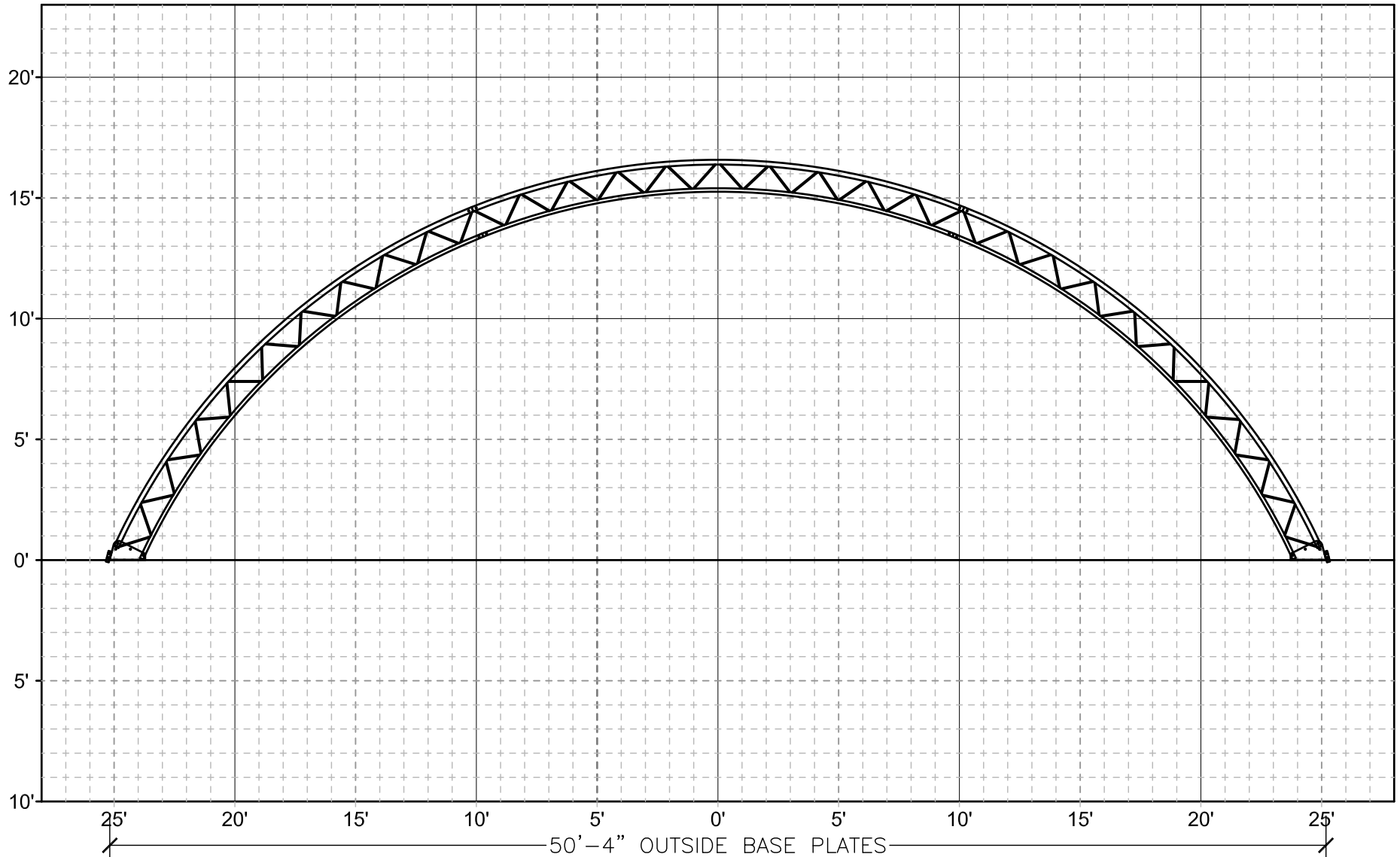

1'x1' GRID